

# Temporary Road Closure & No waiting at any time

**WHERE ?**    Road Closure  
St Catherine's Wynd, Dunfermline (from its junction with  
Maygate to its termination)

No Waiting at any time  
St Catherine's Wynd, Dunfermline (from outside property no.  
25 to the entrance to Pittencrieff Park – both sides).

Access for emergency service vehicles will be maintained.

Pedestrian access will be maintained.

**WHEN ?**    From 8am on Monday 6<sup>th</sup> January 2025 to 12pm on Friday  
17<sup>th</sup> January 2025.

**WHY ?**        To allow inspection works to be carried out in safety.

**WHO ?**        Contraflow are responsible for these works and can be  
contacted as follows:

Project Engineer:                      01236 862 400



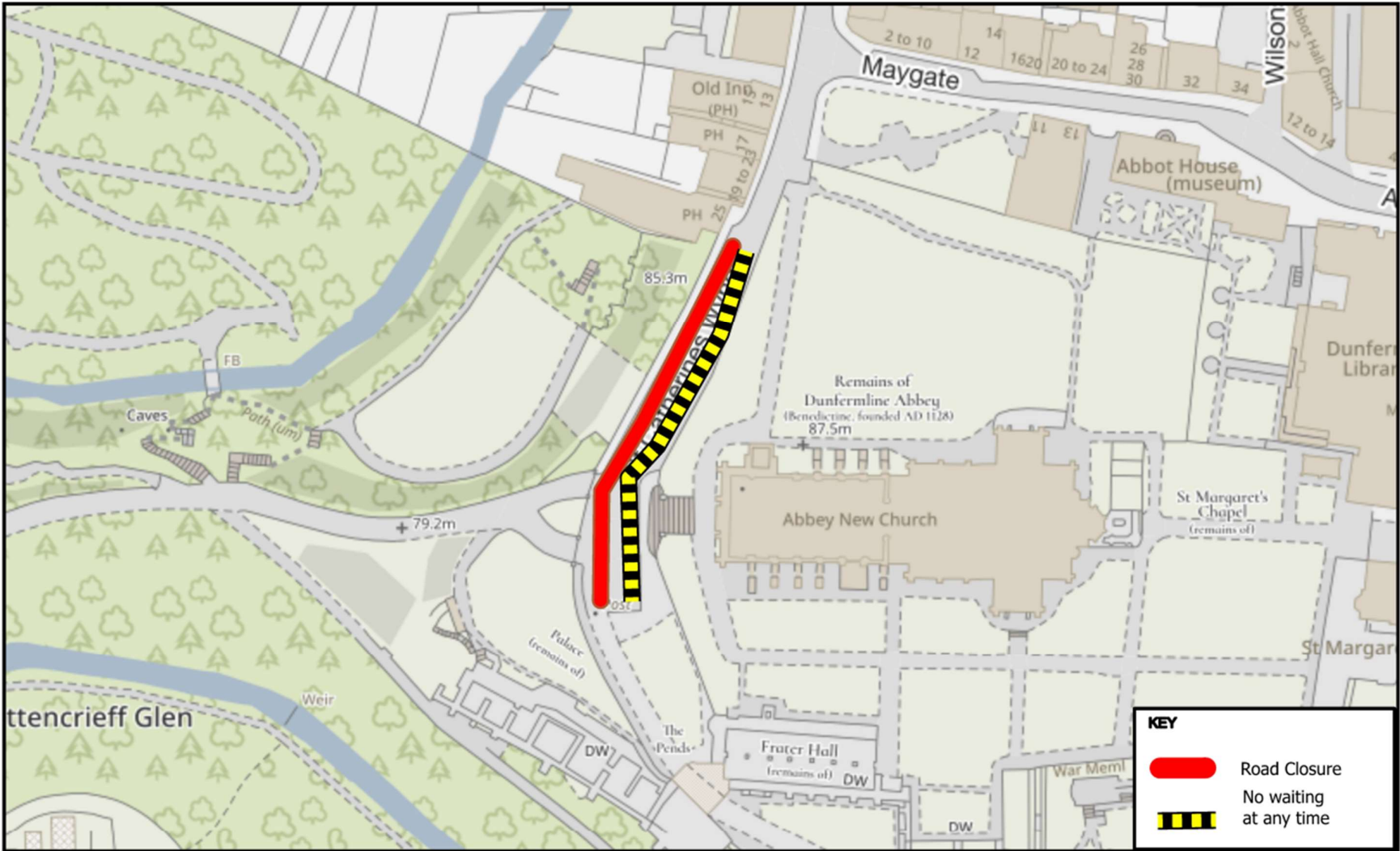

© Crown copyright and database rights 2024.  
 Ordnance Survey 100023385  
 Aerial Photography © copyright Getmapping.

N  
  
 Scale: 1:1,000

**St Catherine's Wynd, Dunfermline**  
 Prepared By: NDD  
 Service: Roads & Transportation

