

Island Detail

Dimensions: 1 m wide x 2 m long.
 Keep left bollard to be positioned in centre of island to standard detail CS/SD14/17.
 Keep left aspect is to be on both front and rear of bollard.
 Bollard is to be a self-righting bollard.
 Island to be recycled rubber bolt down type.
 Island edges to have white reflective perimeter edge.
 See sample spec from www.rediweldtraffic.co.uk
 Module numbers relate to Rediweld modules.

Northbound lane	3	3	Southbound lane
	4	4	
	4	4	
	3	3	

RM-A.

- Refresh existing centre hatching as shown (partially faded).
- Remove 2 no. tuck in deflection arrows as shown in RED.

A. (327118,687668)

- Supply and install new bolt down rubber island 1 m wide x 2 m long in centre of carriageway. Keep left bollard to be supplied and fitted in centre of island.
- Construct 2 no. speed cushions - at new island. Each cushion should be centred in the running lane.

B. (327088,687593)

Construct 2 no. speed cushions at existing traffic island. Each cushion should be centred in the running lane.

C. (327084,687515)

Construct raised table and widen footway.

Works Overview

Construct speed cushions (4 no. total).
 Supply and install rubber bolt down island with self-righting bollard.
 Construct raised table.
 Construct approx. 25 m long x 2 m footway (includes reprofiling short section of existing footway).

Safety Notes

Road is an "A" class single carriageway with 20 mph.
 Risk of striking underground services - see attached Public Utility plans.
 There are High Voltage cables and Medium Pressure Gas mains at works location - marked indicatively.
 There may be other services present and the Contractor shall take appropriate measures to locate them.
 Road is a bus route.

Notes

Raised table to be constructed at 75 mm high to standard detail CS/SD11/38.
 Speed cushions to be 1.8 m wide x 3 m long x 75 mm high to standard detail C1/03/01/002.
 Speed cushions to have solid white line marked around its perimeter.
 Hump triangles to Dia. 1062.
 Road markings to be laid in white thermoplastic screed and reflectorised with glass beads in accordance with TSM Chapter 5 Table 12-1.

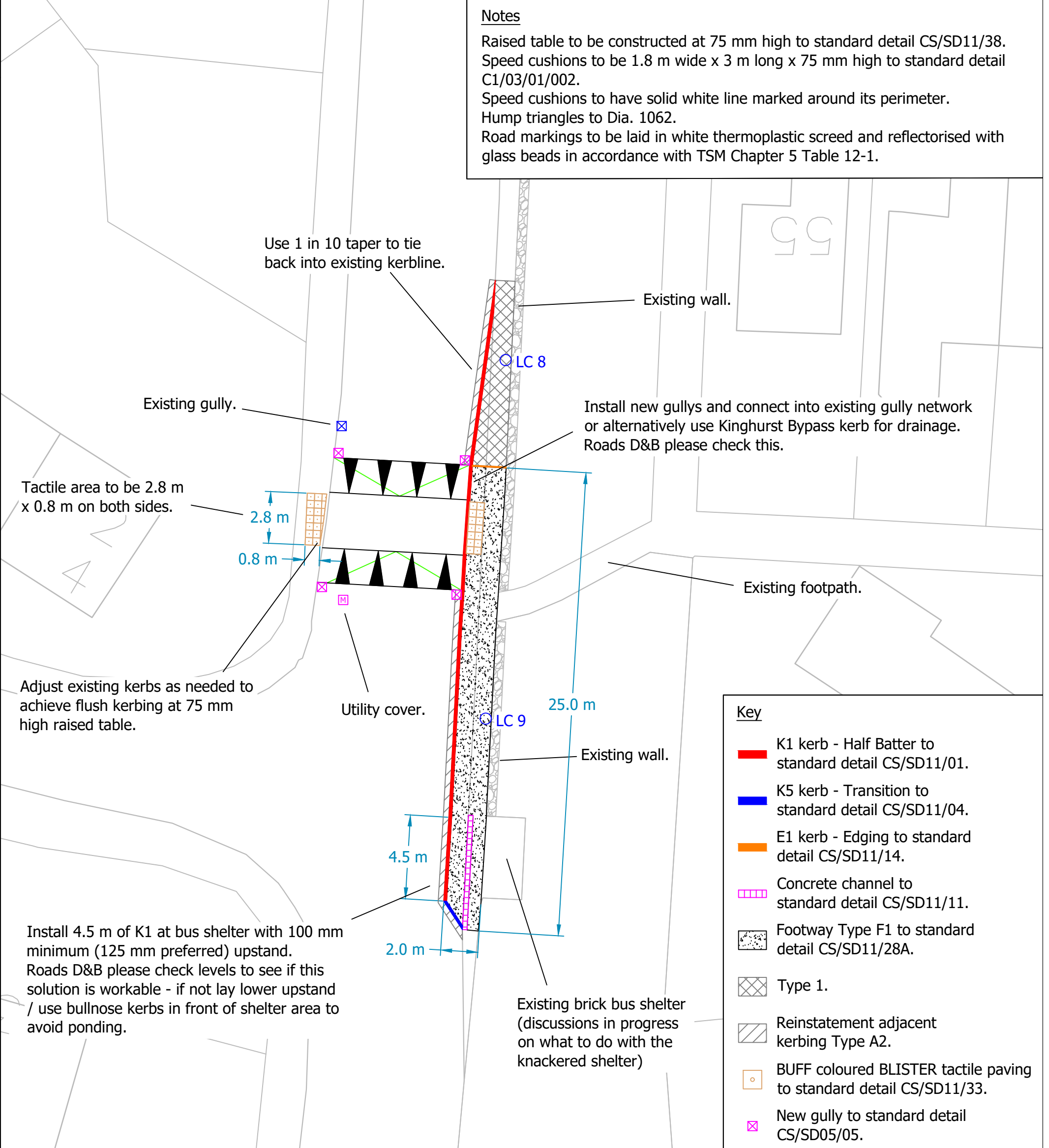
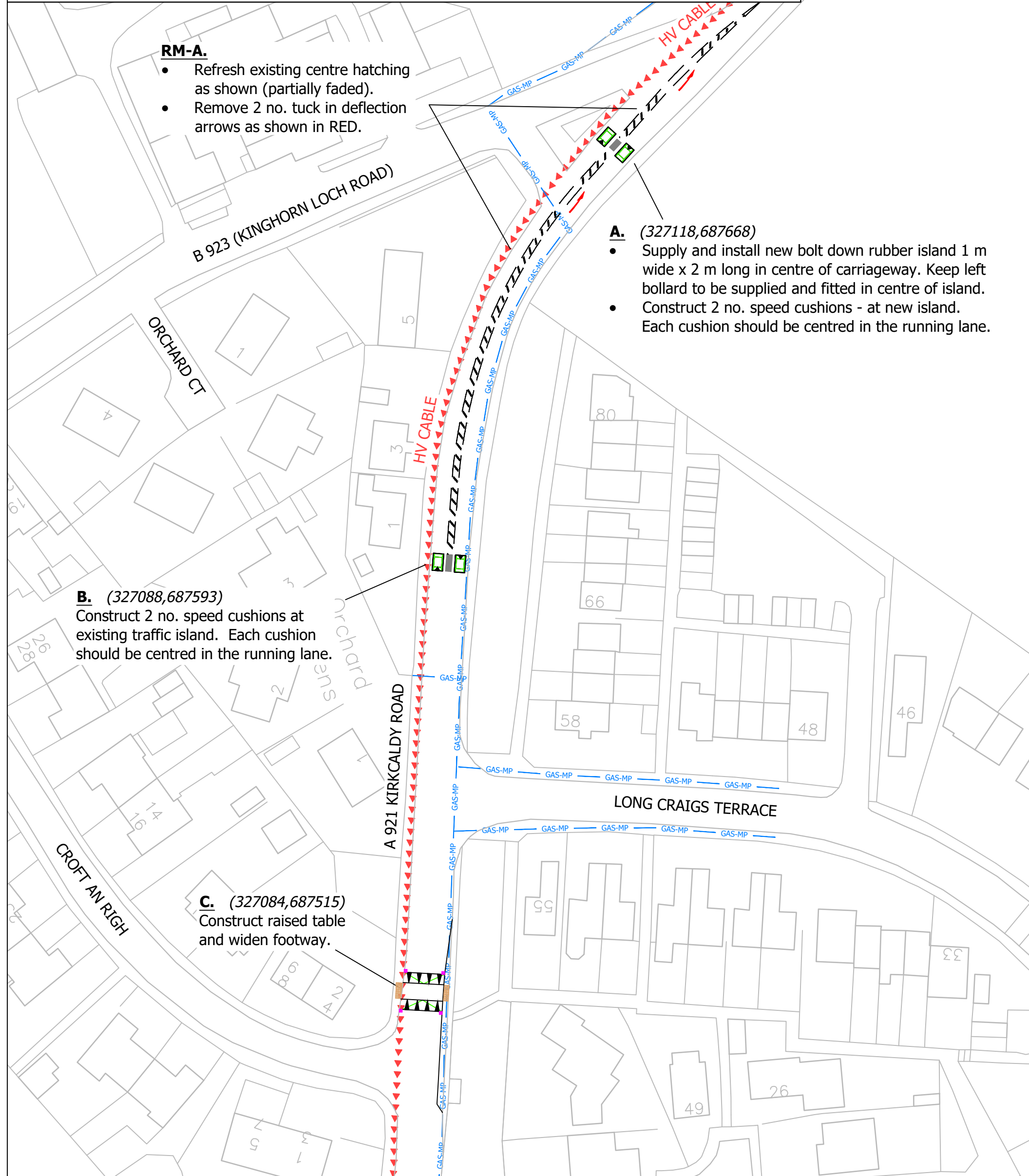

Key

- K1 kerb - Half Batter to standard detail CS/SD11/01.
- K5 kerb - Transition to standard detail CS/SD11/04.
- E1 kerb - Edging to standard detail CS/SD11/14.
- Concrete channel to standard detail CS/SD11/11.
- Footway Type F1 to standard detail CS/SD11/28A.
- Type 1.
- Reinstatement adjacent kerbing Type A2.
- BUFF coloured BLISTER tactile paving to standard detail CS/SD11/33.
- New gully to standard detail CS/SD05/05.

A	KEEP RIGHT BOLLARD CHANGED TO KEEP LEFT BOLLARD	KJ	LC	8/8/24
REV	AMENDMENTS	BY	AP'D	DATE
Traffic Calming and Footway Widening A921 Kirkcaldy Road, Kinghorn		ROADS & TRANSPORTATION SERVICES HEAD OF SERVICE - JOHN MITCHELL		
SCALE 1:200 A2	DRAWING No. 00425	APPROVED LC DATE AUGUST 2024		
DESIGNED KJ	DRAWN KJ	CHECKED LC	DATE AUGUST 2024	